



AD-SBDD20200CT Plastic-Encapsulated Diode

AD-SBDD20200CT Schottky barrier diode

MAIN CHARACTERISTICS

| | |
|--------------|--------------------------------------|
| I_o | 20A (2X10A) |
| V_{RRM} | 200V |
| T_j | 150°C |
| $V_{F(typ)}$ | 0.76V (@ $T_j = 125^\circ\text{C}$) |

FEATURES

- Low power loss, high efficiency
- High current capability and low forward voltage drop
- Guard ring die construction for transient protection
- AEC-Q101 qualified

MARKING



SBDD20200CT = Device code
XXXX = Date code

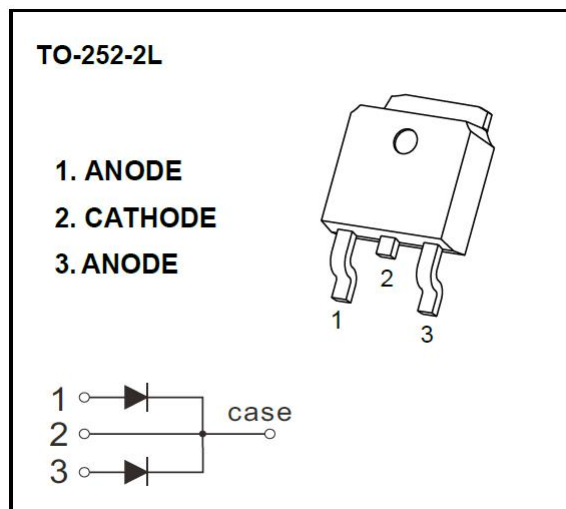

MAXIMUM RATINGS ($T_j = 25^\circ\text{C}$ unless otherwise specified)

| Parameter | Symbol | Value | Unit |
|--|-----------------|-----------|--------------------|
| Peak repetitive reverse voltage | V_{RRM} | 200 | V |
| Working peak reverse voltage | V_{RWM} | 200 | V |
| DC blocking voltage | V_R | 200 | V |
| RMS reverse voltage | $V_{R(RMS)}$ | 140 | V |
| Average rectified output current | I_O | 20 | A |
| Non-repetitive peak forward surge current @ $t = 8.3\text{ms}$ | I_{FSM} | 150 | A |
| Thermal resistance from junction to case | $R_{\theta JC}$ | 5.0 | $^\circ\text{C/W}$ |
| Thermal resistance from junction to ambient | $R_{\theta JA}$ | 100 | $^\circ\text{C/W}$ |
| Operating junction temperature range | T_j | -40 ~ 125 | $^\circ\text{C}$ |
| Storage temperature range | T_{stg} | -55 ~ 150 | $^\circ\text{C}$ |

ELECTRICAL CHARACTERISTICS ($T_j = 25^\circ\text{C}$ unless otherwise specified)

| Parameter | Symbol | Test condition | Min | Typ | Max | Unit | |
|---------------------------------|------------|------------------------|---------------------------|-----|------|------|---------------|
| Reverse breakdown voltage | $V_{(BR)}$ | $I_R = 100\mu\text{A}$ | 200 | - | - | V | |
| Reverse voltage leakage current | I_R | $V_R = 200\text{V}$ | $T_j = 25^\circ\text{C}$ | - | 2.0 | 100 | μA |
| | | | $T_j = 125^\circ\text{C}$ | - | 2.0 | - | mA |
| Forward voltage | V_{F1} | $I_F = 5\text{A}$ | $T_j = 25^\circ\text{C}$ | - | 0.8 | - | V |
| | | | $T_j = 125^\circ\text{C}$ | - | 0.68 | - | |
| | V_{F2} | $I_F = 10\text{A}$ | $T_j = 25^\circ\text{C}$ | - | 0.86 | 0.95 | |
| | | | $T_j = 125^\circ\text{C}$ | - | 0.76 | - | |

TYPICAL CHARACTERISTICS

FIG.1: FORWARD CURRENT DERATING CURVE

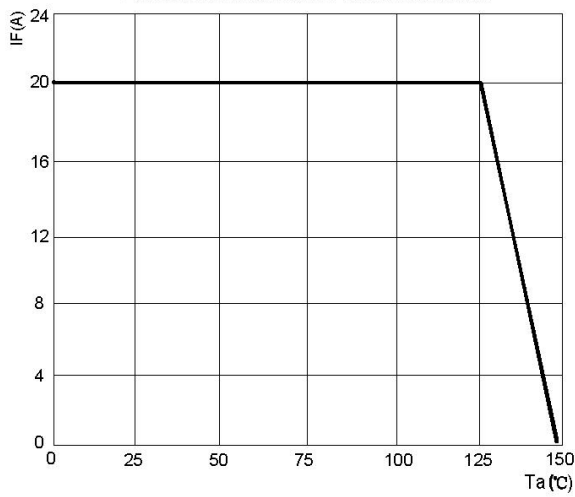

FIG.2: TYPICAL FORWARD CHARACTERISTICS

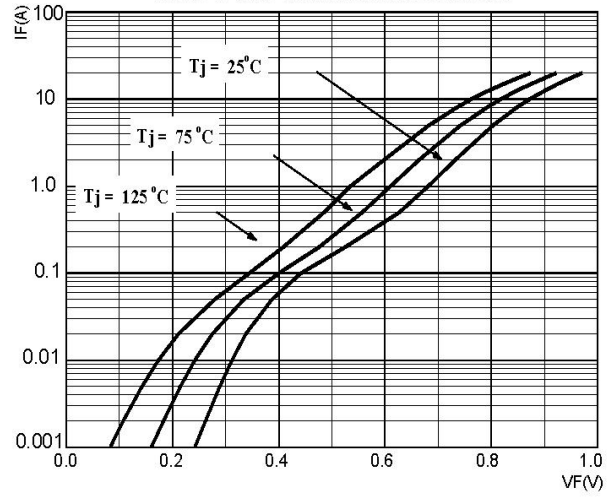

FIG.3: TOTAL CAPACITANCE DERATING CURVE

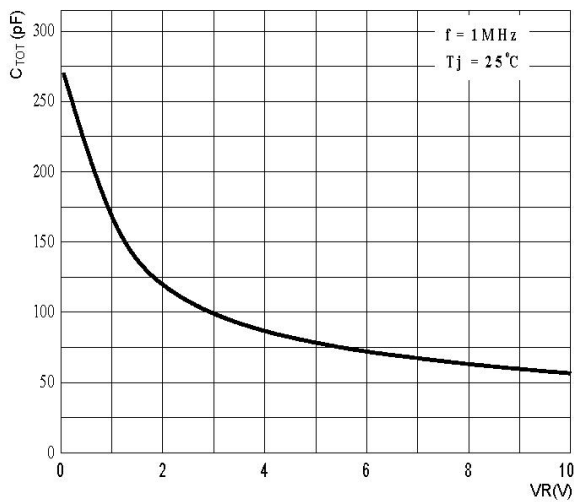
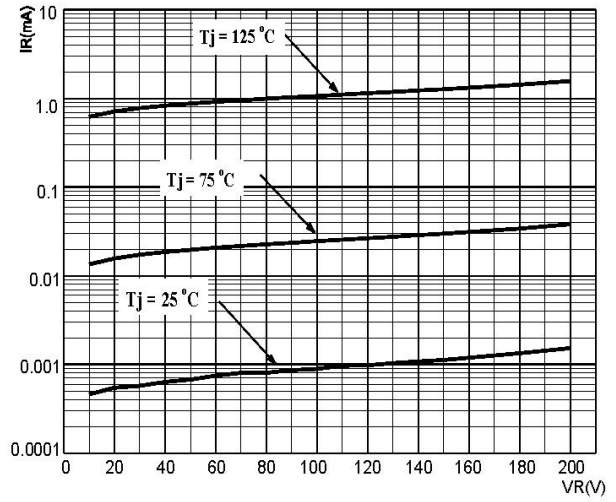
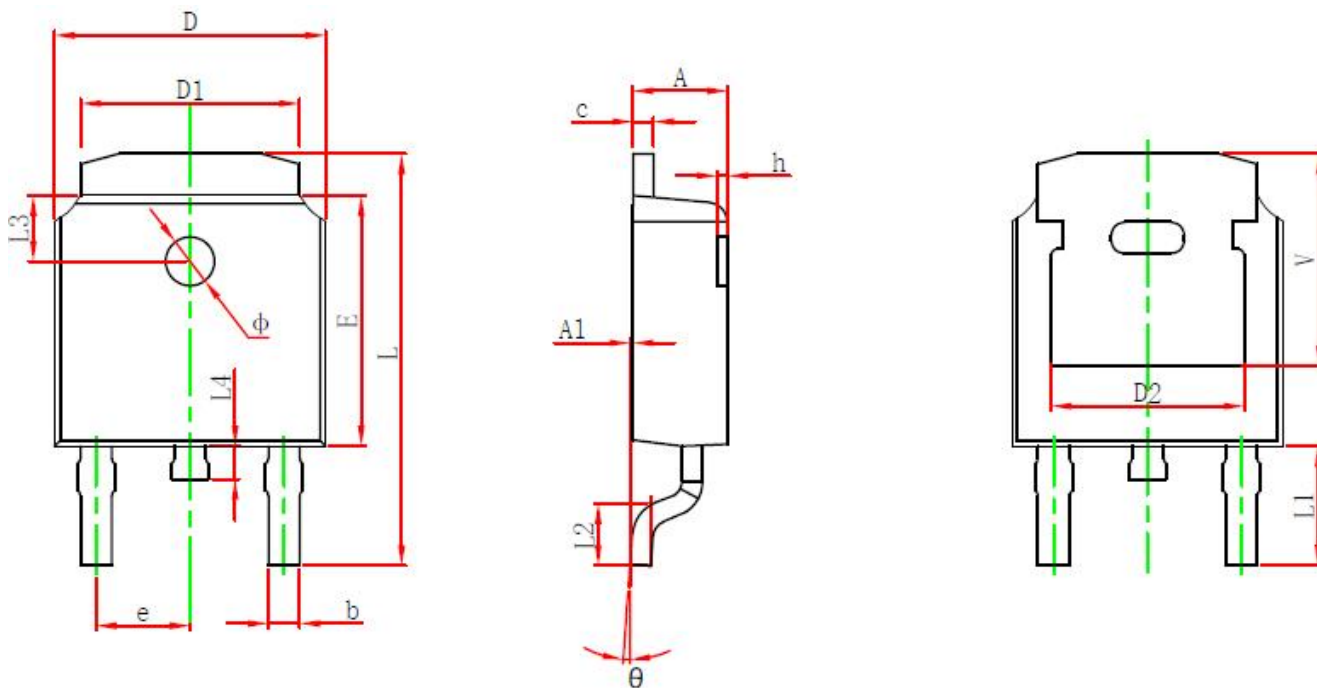

FIG.4: TYPICAL REVERSE CHARACTERISTICS



TO-252-2L PACKAGE OUTLINE DIMENSIONS



| Symbol | Dimensions In Millimeters | | Dimensions In Inches | |
|--------|---------------------------|--------|----------------------|-------|
| | Min. | Max. | Min. | Max. |
| A | 2.200 | 2.400 | 0.087 | 0.094 |
| A1 | 0.000 | 0.127 | 0.000 | 0.005 |
| b | 0.635 | 0.770 | 0.025 | 0.030 |
| c | 0.460 | 0.580 | 0.018 | 0.023 |
| D | 6.500 | 6.700 | 0.256 | 0.264 |
| D1 | 5.100 | 5.460 | 0.201 | 0.215 |
| D2 | 4.830 REF. | | 0.190 REF. | |
| E | 6.000 | 6.200 | 0.236 | 0.244 |
| e | 2.186 | 2.386 | 0.086 | 0.094 |
| L | 9.712 | 10.312 | 0.382 | 0.406 |
| L1 | 2.900 REF. | | 0.114 REF. | |
| L2 | 1.400 | 1.700 | 0.055 | 0.067 |
| L3 | 1.600 REF. | | 0.063 REF. | |
| L4 | 0.600 | 1.000 | 0.024 | 0.039 |
| φ | 1.100 | 1.300 | 0.043 | 0.051 |
| θ | 0° | 8° | 0° | 8° |
| h | 0.000 | 0.300 | 0.000 | 0.012 |
| V | 5.250 REF. | | 0.207 REF. | |

TO-252-2L SUGGESTED PAD LAYOUT

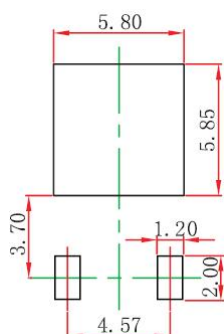

Note:

1. Controlling dimension in millimeters.
2. General tolerance: ±0.05mm.
3. The pad layout is for reference purpose only.

TO-252-2L TAPE AND REEL

TO-252 Embossed Carrier Tape

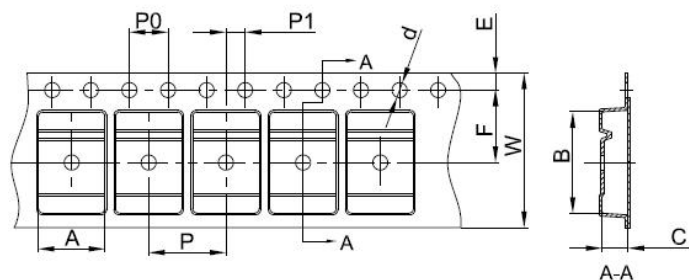

Packaging Description:

TO-252 parts are shipped in tape. The carrier tape is made from a dissipative (carbon filled) polycarbonate resin. The cover tape is a multilayer film (Heat Activated Adhesive in nature) primarily composed of polyester film, adhesive layer, sealant, and anti-static sprayed agent. These reeled parts in standard option are shipped with 25,00 units per 13" or 33.0 cm diameter reel. The reels are clear in color and is made of polystyrene plastic (anti-static coated).

| Dimensions are in millimeter | | | | | | | | | | |
|------------------------------|------|-------|------|-------|------|------|------|------|------|-------|
| Pkg type | A | B | C | d | E | F | P0 | P | P1 | W |
| TO-252 | 6.90 | 10.50 | 2.70 | Ø1.55 | 1.75 | 7.50 | 4.00 | 8.00 | 2.00 | 16.00 |

TO-252 Tape Leader and Trailer

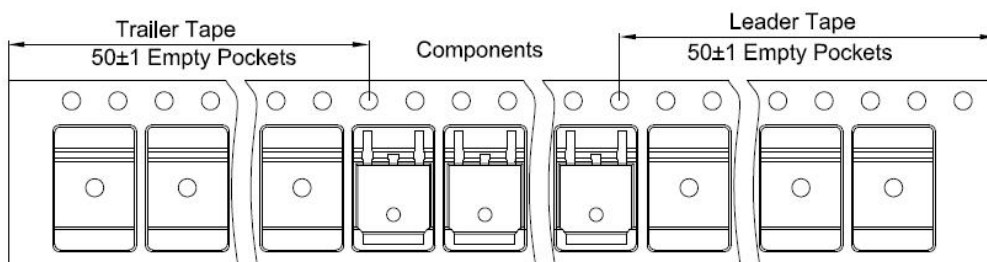

TO-252 Reel

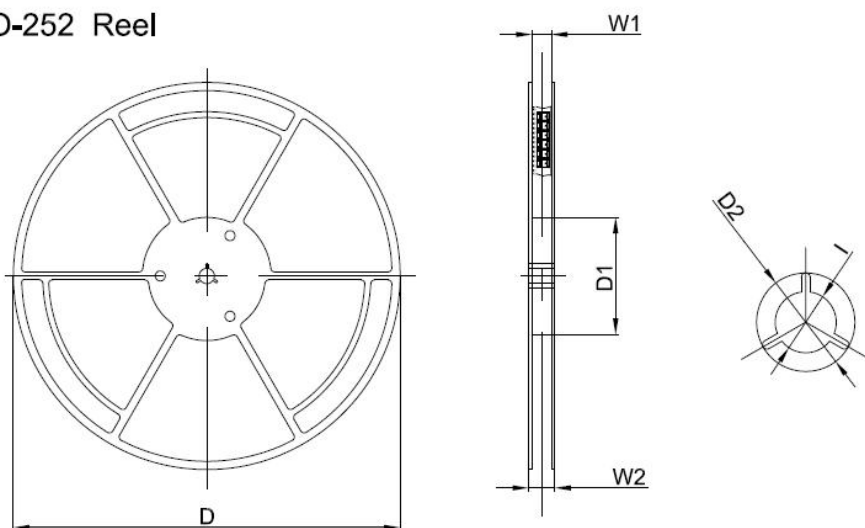

| Dimensions are in millimeter | | | | | | |
|------------------------------|--------|--------|--------|-------|-------|--------|
| Reel Option | D | D1 | D2 | W1 | W2 | l |
| 13" Dia | 330.00 | 100.00 | Ø21.00 | 16.40 | 21.00 | Ø13.00 |

| REEL | Reel Size | Box | Box Slze(mm) | Carton | Carton Slze(mm) | G.W.(kg) |
|-----------|-----------|-----------|--------------|------------|-----------------|----------|
| 2,500 pcs | 13Inch | 2,500 pcs | 340×336×29 | 25,000 pcs | 353×346×365 | |

PUBLISHED BY**JIANGSU CHANGJING ELECTRONICS TECHNOLOGY CO., LTD.**

13th Floor, C Block, Tengfei Building, Yan Chuang Yuan, Nanjing Jiangbei New Area, China

LEGAL DISCLAIMER

The information given in this document shall in no event be regarded as a guarantee of conditions or characteristics. With respect to any examples, hints or typical values stated herein and/or any information regarding the application of the device, JSCJ hereby disclaims any and all warranties and liabilities of any kind, including without limitation, warranties of non-infringement of intellectual property rights of any third party.

In addition, any information given in this document is subject to customer's compliance with its obligations stated in this document and any applicable legal requirements, norms and standards concerning customer's products and any use of the product of JSCJ in customer's applications.

The data contained in this document is exclusively intended for technically trained staff. It is the responsibility of customer's technical departments to evaluate the suitability of the product for the intended application and the completeness of the product information given in this document with respect to such application.

INFORMATION

For further information on technology, delivery terms and conditions as well as prices, please contact your nearest JSCJ office (www.jscj-elec.com).

WARNINGS

Due to technical requirements, products may contain dangerous substances. For information on the types in question, please contact your nearest JSCJ office.

Except as otherwise explicitly approved by JSCJ in a written document signed by authorized representatives of JSCJ, JSCJ's products may not be used in any applications where a failure of the product or any consequences of the use thereof can reasonably be expected to result in personal injury.